

Eyebolts (sizes generally to DIN 580)

Size D1 mm	6	8	10	12	16
Inside Dia. D4 mm	16	20	25	30	35
Length of L Shank	13	13	17	20.5	27
Height of Base E mm	6	6	8	10	12
Total Height H mm	34	36	45	53	62
Weight per 100 pcs/kg	3	6	10.3	17.7	28

LARGER SIZES AVAILABLE UPON REQUEST

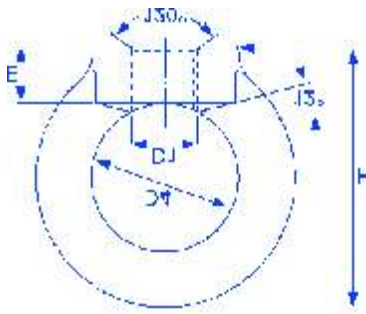
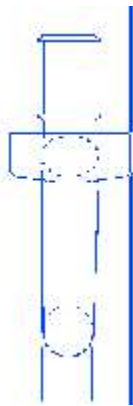

Eyenuits (sizes generally to DIN 582)

Size D1 mm	6	8	10	12	16
Inside Dia. D4 mm	20	20	25	30	35
Height of Base E mm	8.5	8.5	10	11	13
Total Height H mm	34	36	45	53	62
Weight per 100 pcs/kg	4.2	5.2	9.4	16	24

LARGER SIZES AVAILABLE UPON REQUEST

