

Long Shank Collared Eyebolts Whitworth Thread Tested & Certified

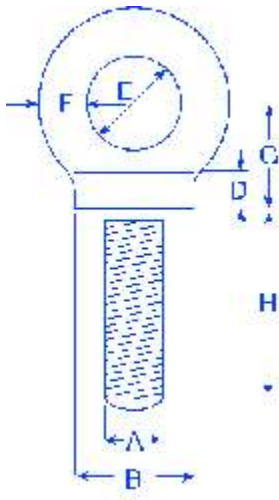

| Vertical SWL Tons | 0.25 | 0.50 | 0.90 | 1.40 | 2.00 | 2.75 |
|------------------------|-------|-------|---------|---------|---------|-------|
| A inches | 3/8 | 1/2 | 5/8 | 3/4 | 7/8 | 1 |
| B inches | 27/32 | 1 1/8 | 1 13/32 | 1 11/16 | 1 31/32 | 2 1/4 |
| D inches | 9/32 | 3/8 | 15/32 | 9/16 | 21/32 | 3/4 |
| E inches | 9/16 | 3/4 | 15/16 | 1 1/8 | 1 5/16 | 1 1/2 |
| F inches | 11/32 | 7/16 | 9/16 | 21/32 | 25/32 | 7/8 |
| G inches | 3/4 | 1 | 1 1/4 | 1 1/2 | 1 3/4 | 2 |
| H inches | 7 | 7 | 7 | 7 | 7 | 7 |
| Weight Kgs/each | 0.18 | 0.25 | 0.44 | 0.70 | 1.05 | 1.50 |

Long Shank Collared Eyebolts Metric Thread Tested & Certified

| Vertical SWL Tons | 0.25 | 0.40 | 0.80 | 1.60 | 2.50 |
|------------------------|------|------|------|------|------|
| A mm | 10 | 12 | 16 | 20 | 24 |
| B mm | 22 | 28 | 36 | 43 | 57 |
| D mm | 7 | 10 | 12 | 14 | 19 |
| E mm | 15 | 19 | 24 | 28 | 38 |
| F mm | 9 | 11 | 14 | 17 | 22 |
| G mm | 20 | 25 | 32 | 38 | 51 |
| H mm | 178 | 178 | 178 | 178 | 178 |
| Weight Kgs/each | 0.18 | 0.25 | 0.44 | 0.70 | 1.50 |

Long Shank Dynamo Eyebolts Metric Thread Tested & Certified

| Vertical SWL Tons | 0.15 | 0.25 | 0.32 | 0.63 | 1.25 | 2.00 |
|------------------------|------|------|------|------|------|------|
| A mm | 8 | 10 | 12 | 16 | 20 | 24 |
| E mm | 22 | 22 | 29 | 32 | 41 | 51 |
| F mm | 9.5 | 9.5 | 11 | 13 | 16 | 19 |
| G mm | 27 | 27 | 35 | 41 | 54 | 64 |
| H mm | 100 | 100 | 100 | 114 | 127 | 127 |
| B mm | 19 | 19 | 25 | 29 | 35 | 41 |
| D mm | 6 | 6 | 8 | 9.5 | 11 | 13 |
| Weight Kgs/each | 0.11 | 0.12 | 0.17 | 0.35 | 0.60 | 1.10 |