

DIN 580 Eyebolts



Eyebolts meet the performance requirements of DIN 580 Tested & Certified

Vertical SWL Kgs	N/A	140	230	340	700	1200	1800	N/A	3600
D1 mm	6*	8	10	12	16	20	24	27*	30
D4 mm	20	20	25	30	35	40	50	60	60
H mm	36	36	45	53	62	71	90	109	109
K mm	8	8	10	12	14	16	20	24	24
L mm	13	13	17	20.5	27	30	36	45	45
Weight Kgs/each	0.06	0.06	0.11	0.18	0.28	0.45	0.74	1.56	1.66

***THESE SIZES ARE ADDITIONAL TO THE SPECIFICATION**

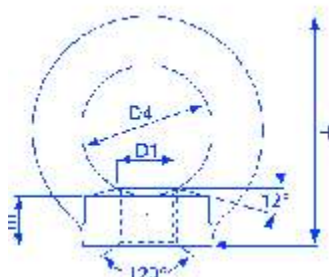

DIN 582 Eyenuts

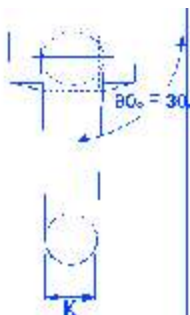

Eyenuts meet the performance requirements of DIN 582 Tested & Certified

Vertical SWL Kgs	N/A	140	230	340	700	1200	1800	N/A	3600
D1 mm	6*	8	10	12	16	20	24	27*	30
D4 mm	20	20	25	30	35	40	50	60	60
H mm	36	36	45	53	62	71	90	109	109
K mm	8	8	10	12	14	16	20	24	24
Weight Kgs/each	0.05	0.05	0.09	0.16	0.24	0.36	0.72	1.22	1.32

***THESE SIZES ARE ADDITIONAL TO THE SPECIFICATION**